

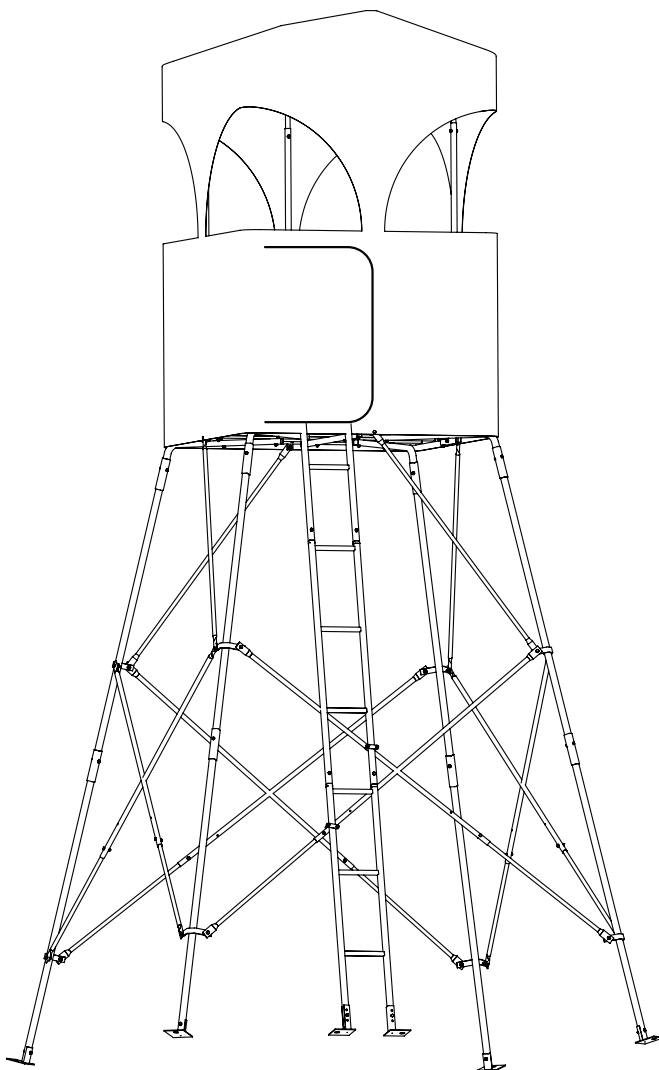

Operator's Manual
RE703
Outpost™ Tower



Certified to
TMA Standards
by an Independent
Testing Laboratory

Get parts online at
www.huntriversedge.com

Maximum Field Rating - 500 lbs.



OMRE70309
ECN: 10325
REV2: 02/28/14
© 2014 RETI.
All Rights Reserved.

INTRODUCTION

Rivers Edge® Treestands are engineered with you, the hunter, in mind. We appreciate your purchase of one of our world class treestands. Follow these few simple instructions and your stand will provide you many years of trouble-free pleasure. Instructions should be kept in a safe place and reviewed at least annually. If for any reason you have a problem with your product, **DO NOT return to the retailer**, contact the Rivers Edge® customer service department at 800-450-EDGE (3343) for assistance.

CONTENTS

Introduction/Warranty	2
Warnings.....	3
Inspection and Maintenance Schedule for all RiversEdge Products	4
Assembly and Use Instructions	5-14
Illustrated Parts Breakdown.....	15-17
Bolt Guide	18
Notes:.....	19

WARRANTY

Rivers Edge Tree Stands, Inc. ("RETI") offers a one year warranty for all components of the treestand. These warranties apply to the original owner with a proof of purchase. These warranties begin on the date of purchase by the first retail consumer and continue for the period specified above. These warranties apply to products that are not modified, abused or used in a manner that deviates from the product's intended usage. Minor fading in color is normal and is not covered by warranty. Any corrosion of painted surfaces that occurs as a result of paint being removed or damaged is also not covered by warranty. RETI offers no other warranty expressed or implied. Products for which warranty work has been approved must be sent directly to RETI and performed by RETI. **To obtain warranty service and/or replacement instructions, you must obtain prior approval from Rivers Edge® Treestands before shipping your package to us by calling our customer service department at 800-450-EDGE (3343) or by writing to: Rivers Edge Tree Stands, Inc., P.O. Box 755, 1160 Eighth Avenue, Cumberland, WI 54829 for a return material authorization number (RMA#).** All items must be shipped prepaid. RETI will, at no charge, repair or replace, in RETI's sole discretion, any product that satisfies the conditions stated above. RETI retains the right to change models, specifications and price without notice.

This equipment has been manufactured under strict quality and safety guidelines. As with any equipment of this type, full understanding of the instructions and its use is mandatory and imperative for the safety of its user. RETI is not responsible for any damages or injuries sustained due to improper use or modification of any of its products, or resulting from any use which deviates from the product's intended usage. RETI is not responsible for any injuries sustained due to failure to read and adhere to the instructions for use. Any misunderstanding or questions regarding the products of their use should be directed to RETI prior to any use. It is the owner's sole responsibility to inspect the product regularly for damage, improper installation, or conditions that could jeopardize the ultimate safety of the product. **Owner is responsible to understand and follow product field weight rating and must never exceed maximum weight rating.** RETI is not responsible for any malfunction or injury resulting from normal wear and tear, damage caused by improper use, improper maintenance, negligence or accidents. This product, if used safely as intended, will provide trouble free service for the useful life of the product. We hope you will enjoy the quality of our products for years to come, and have a safe hunt. **For replacement parts, phone 800-450-EDGE (3343) or go online to www.huntriversedge.com.**

WARNINGS



WARNING

DO NOT USE THIS PRODUCT UNTIL YOU HAVE WATCHED THE INCLUDED TREESTAND SAFETY DVD, UNDERSTAND IT AND PRACTICED THE TECHNIQUES FOR SAFE HUNTING DISCUSSED IN THIS DVD.

BEFORE EACH USE, READ, UNDERSTAND, AND FOLLOW ALL ASSEMBLY, INSPECTION, MAINTENANCE, AND USE INSTRUCTIONS PROVIDED. FAILURE TO FOLLOW ALL WARNINGS AND INSTRUCTIONS COULD RESULT IN SERIOUS INJURY OR DEATH.

READ AND PERFORM ALL INSPECTION AND MAINTENANCE TASKS BEFORE EACH AND EVERY USE (REPLACE ANY QUESTIONABLE COMPONENTS IMMEDIATELY WITH RIVERS EDGE® ORIGINAL REPLACEMENT PARTS). DO NOT LEAVE YOUR STAND OUTDOORS WHEN NOT IN USE.

INSTRUCTIONS SHOULD BE KEPT IN A SAFE PLACE AND REVIEWED AT LEAST ANNUALLY. IT IS THE RESPONSIBILITY OF THE TREESTAND OWNER TO FURNISH THE COMPLETE INSTRUCTIONS TO ANY PERSON WHO BORROWS OR PURCHASES THE TREESTAND.

DOUBLE CHECK ASSEMBLY STEPS TO BE CERTAIN YOU HAVE CORRECTLY ASSEMBLED THIS PRODUCT.

DO NOT CRUSH TUBING WHEN TIGHTENING BOLT ASSEMBLIES! IDENTIFY AND FAMILIARIZE YOURSELF WITH ALL PARTS BEFORE YOU START. A BOLT IDENTIFICATION CHART IS FOUND IN THE BACK OF THIS MANUAL.

DO NOT EXCEED THE TOTAL FIELD RATING - 500 LB., NO MORE THAN 300 LB PER PERSON.

NEVER USE ANY PRODUCT THAT HAS NOT BEEN MAINTAINED OR INSPECTED PROPERLY - YOUR LIFE DEPENDS ON IT!

WHEN HUNTING FROM A TREESTAND, FALLS CAN OCCUR ANY TIME AFTER LEAVING THE GROUND CAUSING INJURY OR DEATH.

REPLACE ANY AND ALL TREESTAND STRAPS EVERY TWO YEARS OR WHEN ANY SIGNS OF DAMAGE OR WEAR EXIST BEFORE.

BE SURE TO RAISE AND LOWER YOUR WEAPON AND GEAR WITH A HAUL LINE. GUN BARREL END AND ARROW TIPS MUST BE POINTED DOWN- AWAY FROM YOU.



WARNING

ALL ASSEMBLY MUST BE DONE IN THIS ORDER AT GROUND LEVEL BEFORE UPRIGHTING.

NEVER EXCEED THE MAXIMUM STATED USE HEIGHT.

CHECK EVERY LADDER SECTION CONNECTION EVERY TIME YOU USE THE STAND BEFORE YOU LEAVE THE GROUND. IF LADDER SECTIONS ARE SEPARATING, DO NOT USE THE STAND.

BE SURE ALL LADDER SECTIONS ARE SEATED COMPLETELY TOGETHER ON SWEDGED OR POCKETED ENDS OF PIPE.

LUBRICATION IS HIGHLY RECOMMENDED AT SLIDE TOGETHER POINTS OF EACH SECTION TO PREVENT BINDING.

DO NOT POSITION THIS PRODUCT ON A SLOPE, UNLEVEL, OR WET GROUND. IT MAY TIP OVER AND YOU COULD BE SERIOUSLY INJURED OR DEATH MAY OCCUR!

GROUND SHOULD BE SUCH THAT GROUND STAKES (NOT INCLUDED) CAN BE DRIVEN INTO THE GROUND THROUGH HOLES PROVIDED IN FOOT PADS. THIS WILL HELP PREVENT TOWER FROM TIPPING OVER IN STRONG WINDS. YOU WILL NEED TO MAKE OR PURCHASE (4) GROUND STAKES. STAKES SHOULD BE 3/8" ROD X 24" LONG.

IT IS HIGHLY RECOMMENDED THAT YOU PURCHASE AND USE THE UNIVERSAL TIE-DOWN KIT WITH GROUND STAKES WITH THIS PRODUCT TO HELP PREVENT PERSONAL INJURY AND/OR PRODUCT DAMAGE FROM TIPPING OVER IN STRONG WINDS!

INSPECT ENTIRE UNIT FOR CORRECT ASSEMBLY BEFORE EVERY USE. BE SURE UNIT HAS A SOLID, STABLE FEEL TO IT AS YOU START YOUR CLIMB. BE SURE UNIT IS LEVEL. BE SURE HANDS ARE FREE FOR CLIMBING.

END YOUR HUNT AND RETURN TO THE GROUND IF INCLEMENT CONDITIONS ARISE.

READ AND PERFORM ALL MAINTENANCE TASKS AS DESCRIBED IN INSPECTION & MAINTENANCE SECTION. IF ANY INSTRUCTIONS ARE NOT UNDERSTOOD OR IF YOU HAVE A PARTS ISSUE CALL 800-450-3343 (EDGE) BEFORE USING.

ALWAYS...

- Be physically fit, mentally alert, and well rested before using this product.
- Read and understand all instructions before use and save for future reference.
- Be fully aware of foot placement.
- Recommended for adult use only.
- Inspect tower stand for missing parts, all hardware condition, and damage before every application, replace if necessary.
- Remove tower stand when not in use, store product indoors.
- Use only Rivers Edge original replacement parts.
- Lean forward, towards ladder, when ascending and descending ladder.
- Place tower stand on dry, level ground.
- Lubricate all slide together points with powder graphite to prevent binding, wear, rust & noise.
- Have three points of contact while climbing or descending ladder.
- Avoid all electrical power lines.
- Inform someone of the hunting location, where the tower stand will be located and the expected duration of the hunt.
- Carry a signal device such as a mobile phone, radio, whistle, signal flare or personal locator device (PLD) and it must be readily available at all times.
- Inspect the tower stand and all safety devices each time before use.

NEVER...

- Sleep in a tower stand.
- Use on wet, soft, or unstable ground.
- Exceed total field rating of 500 lbs.
- Use a tower stand during inclement weather such as rain, lightning, windstorms or icy conditions and end your hunt and return to the ground if inclement conditions arise.
- Alter the original design of your tower stand.
- Carry a gun or bow while ascending and descending.
- Jump on or use in a careless manner.
- Lean out over edge of device.
- Use when intoxicated or using over-the-counter medication or prescription drugs.
- Use a damaged product, replace with new.
- Loan your tower stand to someone else.
- Use a tower stand when feeling ill, nauseous or dizzy, or if you have a prior medical condition that could cause a problem (i.e., heart condition, joints that lock-up, spinal fusions, etc.) or if you are not well rested.
- Modify your stand in any way by making repairs, replacing parts, altering or adding or attaching anything to it except if explicitly authorized in writing by the manufacturer.

INSPECTION AND MAINTENANCE SCHEDULE**FOR ALL RIVERS EDGE PRODUCTS**

- Inspect all hardware for wear or damage. Make sure there are no missing parts.
- Inspect all nut and bolt assemblies to make sure they are secure.
- Inspect all webbing, rope, cord, and strap assemblies for wear or damage.
- Inspect cables, and cable ends for damage or kinking.
- Inspect all hardware and chain components for damage.
- Inspect for any structural damage to product. (Return to factory for repair or discard product if any damage is found.)
- Lubricate all pivot and slide together points with powder graphite to prevent noise, wear, and rust.
- Inspect entire product for any rust, corrosion, cracks, freezing, excessive heat or rotting damage that may effect the safety of your product. Discard any questionable product.
- Inspect entire product for any structural damage - pay close attention to all weld locations. (Return to factory for repair or discard product if any damage is found.)
- Using correct wrenches inspect all nut & bolt assembly locations and snug up any that may be loose. Be careful not to crush tubing when tightening!
- Inspect and check operation of all cables, cable ends, cord, rope, webbing, and strap or chain assemblies. Replace with factory new any item or assembly that shows signs of wear, damage, kinking, or functions incorrectly.
- Inspect seat. Replace any seat with factory new that shows signs of structural damage or wear.

ASSEMBLY AND USE INSTRUCTIONS:

SELECTING A GOOD LOCATION

Assemble this product only in areas that meet the following criteria! No overhead power lines near area; open, flat, level, dry ground of sufficient size to allow for assembly, uprighting and climbing. Approximate area needed for this is 14' X 24'.

ASSEMBLY INSTRUCTIONS

Tools needed – two 7/16" wrenches, two 1/2" wrenches and a tape measure to measure level ground area needed & cross brace length.

NOTE: It is highly recommended that as much assembly as possible be done in a garage setting because of hardware amount and time involved! Allow between two and four hours for assembly.

IMPORTANT ASSEMBLY NOTE:

Do not tighten any nut and bolt combinations completely until all parts are assembled together! Finger tighten plus one turn of a wrench only! This will temporarily hold the lock nut on the bolt while helping alignment of all parts! After all parts are assembled together, all nut & bolt combinations must be completely tightened.

1. Attach the (2) platforms (TWR15) together using (2) provided 1/4-20 x 2-1/2" bolts, locknuts and washers. **SEE FIGURE 1. DO NOT tighten all nut & bolt assemblies completely!**
2. Attach the center platform joiner tube (TWR32) to the bottom of assembled platforms using (4) provided 1/4-20 x 2-1/2" bolts, locknuts and washers. **SEE FIGURE 1.**
3. Attach (2) outside platform joiner tubes (TWR31) to the bottom of assembled platforms using (4) provided 1/4-20 x 2-1/2" bolts, locknuts and washers. **SEE FIGURE 1.**
4. Attach (4) leg receivers (TWR25) to the bottom four corners of platform using (8) provided 1/4-20 x 2-1/2" bolts, locknuts and washers. **SEE FIGURE 2.**

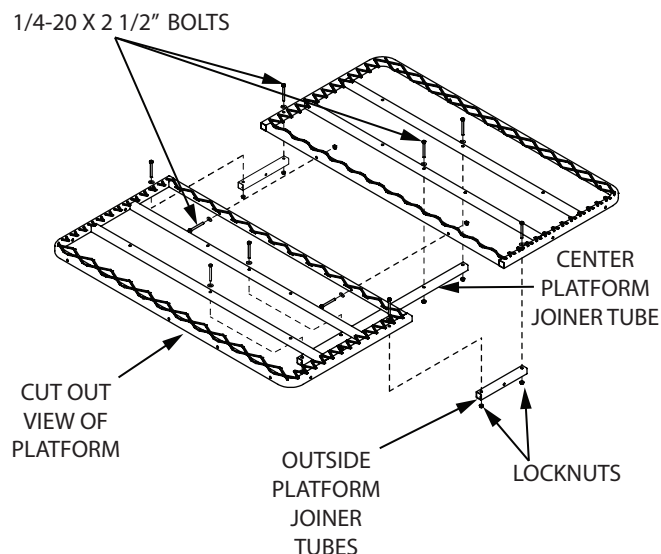

FIGURE 1

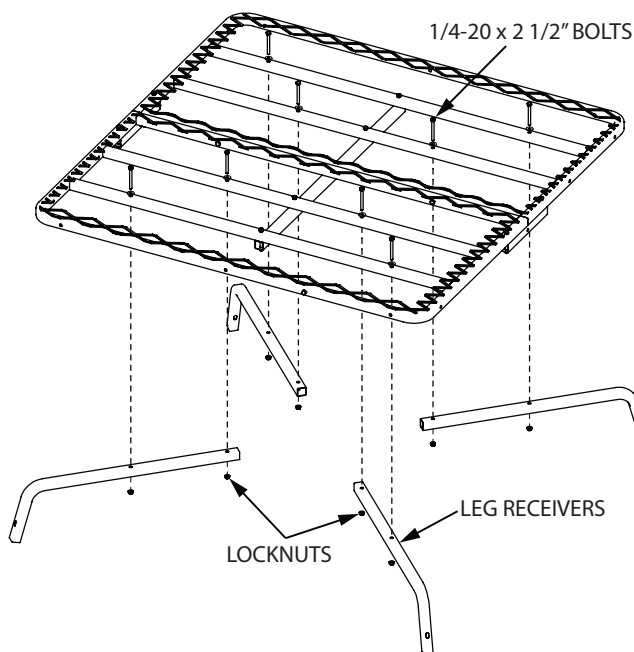
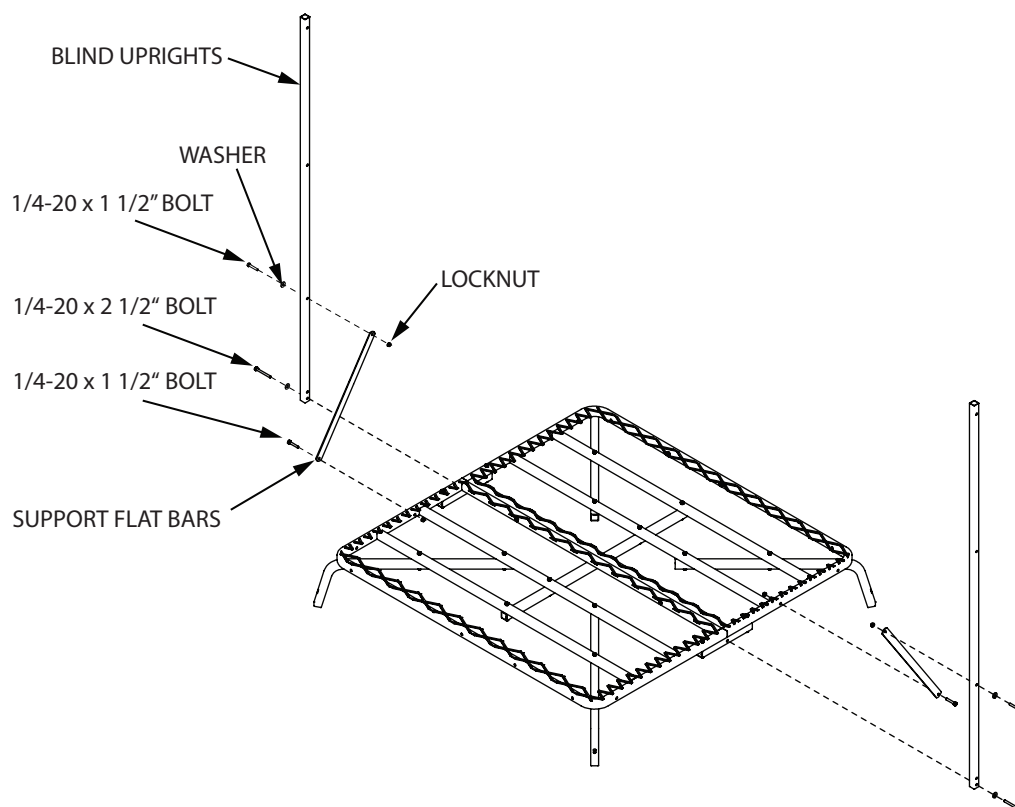
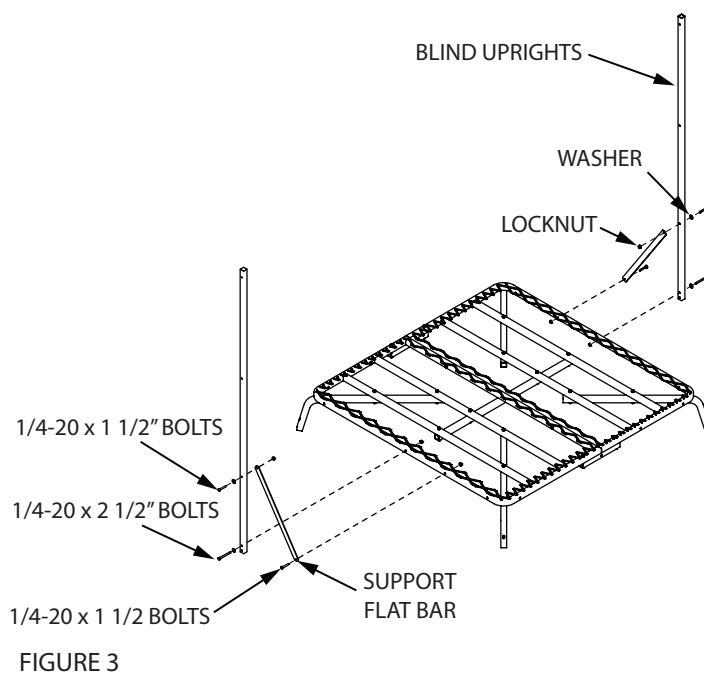

FIGURE 2

5. Attach (2) blind uprights (TWR18) to the long sides of both platforms using (2) provided 1/4-20 x 2-1/2" bolts, locknuts and washers. **SEE FIGURE 3.**
6. Attach remaining (2) blind uprights (TWR18) to the outside platform joiners using (2) provided 1/4-20 x 2-1/2" bolts, locknuts and washers. **SEE FIGURE 4.**
7. Attach (4) upright support flat bars (SL8) to the blind uprights and platform using (8) provided 1/4-20 x 1-1/2" bolt, locknuts and (4) washers. **SEE FIGURE 3 & 4.**

NOTE: Bolt heads should be inserted as shown in figures.
This will help prevent unnecessary wear or interference to the fabric blind.



8. Assemble Blind Rim Rail As follows:

- a. Insert (2) blind rim rails (TWR19) into (2) rail spanner tubes (TWR26) forming a square. Align the four holes and insert (4) provided 1/4-20 x 1-1/4" bolts, locknuts and washers. **SEE FIGURE 5.**
- b. Assemble this square to the inside the four blind uprights by attaching (2) rail spanner tubes to the two blind uprights that are attached to the outside platform joiner using (2) provided 1/4-20 x 2-1/4" bolts, locknuts and washers. **SEE FIGURE 6.**
- c. Attach the two blind rim rails to the two blind uprights that are attached to the long side of both platforms using (2) provided 1/4-20 x 2-1/4" bolts, locknuts and washers. **SEE FIGURE 6.**

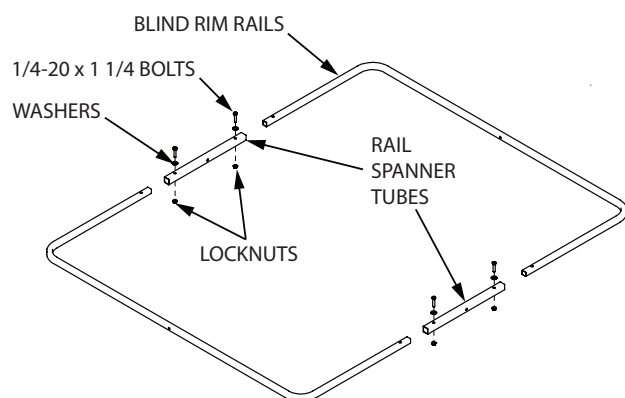

FIGURE 5

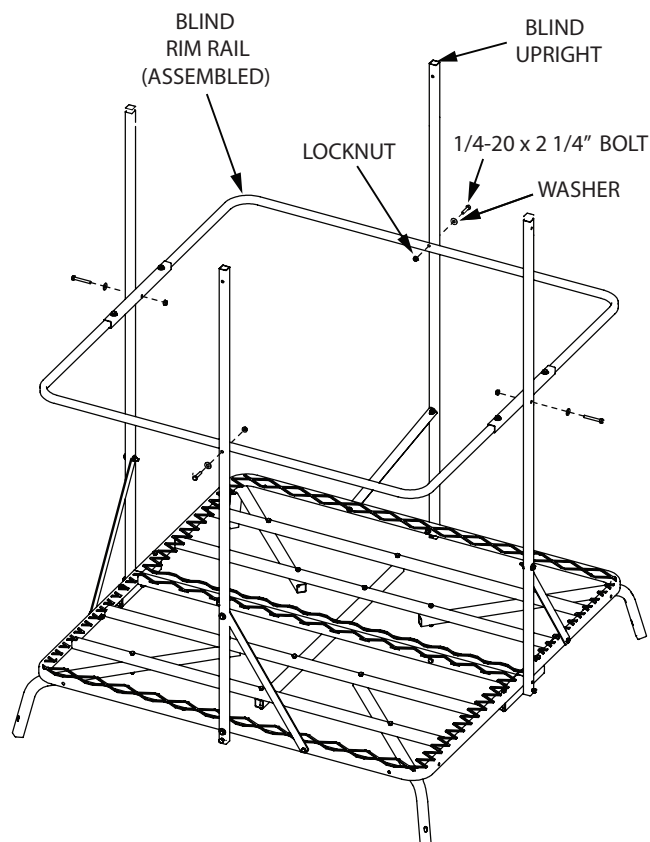
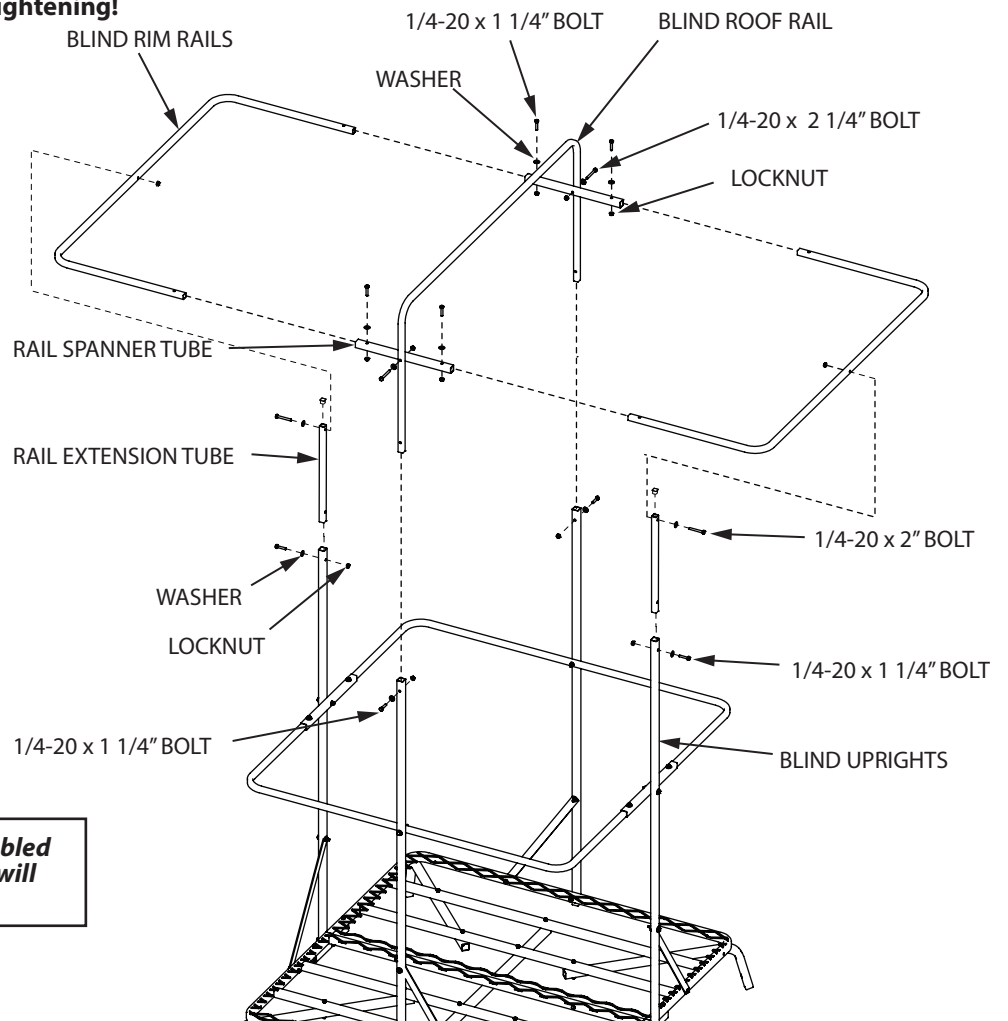

FIGURE 6

9. Insert (2) rail extension tubes (TWR27) into the two blind uprights that are attached to the outside platform joiner using (2) provided 1/4-20 x 1-1/4" bolts, locknuts and washers. **SEE FIGURE 7.**
10. Insert blind roof rail (TWR28) into the two blind uprights that are attached to the long side of both platforms using (2) provided 1/4-20 x 1-1/4" bolts, locknuts and washers. **SEE FIGURE 7.**
11. Assemble Blind Sections as follows:
 - a. Insert (2) blind rim rails (TWR19) into (2) rail spanner tubes (TWR26) forming a square. Align the four holes and insert (4) provided 1/4-20 x 1-1/4" bolts, locknuts and washers. **SEE FIGURE 7.**
 - b. Assemble this square to the inside the rail extension tubes and blind roof rail by attaching (2) rail spanner tubes to the blind roof rail using (2) provided 1/4-20 x 2-1/4" bolts, locknuts and washers. **SEE FIGURE 7.**
 - c. Attach the two blind rim rails to the two rail extension tubes using (2) provided 1/4-20 x 2" bolts, locknuts and washers. **SEE FIGURE 7. You must now tighten all nut & bolt assemblies. Be sure not to over tighten or crush tubing when tightening!**



NOTE: Blind roof rail must be assembled as shown or camo blind cover door will not line up with ladder.

FIGURE 7

12. Attach foot pads (TP113) to four of the eight leg sections (TWR20) using (4) provided 1/4-20 x 1-1/2" bolts and locknuts. **SEE FIGURE 8.** This step now makes these four legs, the bottom section legs.

NOTE: Be sure foot pads are oriented correctly in relation to the welded on bracket of leg section. Channel on foot pads should cradle on three sides of the leg sections. SEE FIGURE 8.

13. Insert each of the four remaining (top) leg sections into the bottom leg sections by inserting into pocketed end of bottom leg section. Attach each section together using (4) 1/4-20 x 1-1/2" bolt and locknut. **SEE FIGURE 8.**

NOTE: Be sure the welded on brackets on each leg section are oriented correctly in relation to each other. SEE FIGURE 8.

14. With assembled platform section laying on its side, insert all four assembled leg sections onto each leg receiver J-pipe using (4) provided 1/4-20 x 1-1/2" bolts and locknuts. **SEE FIGURE 8.**

NOTE: Be sure the foot pads are oriented outward from the platform. SEE FIGURE 8.

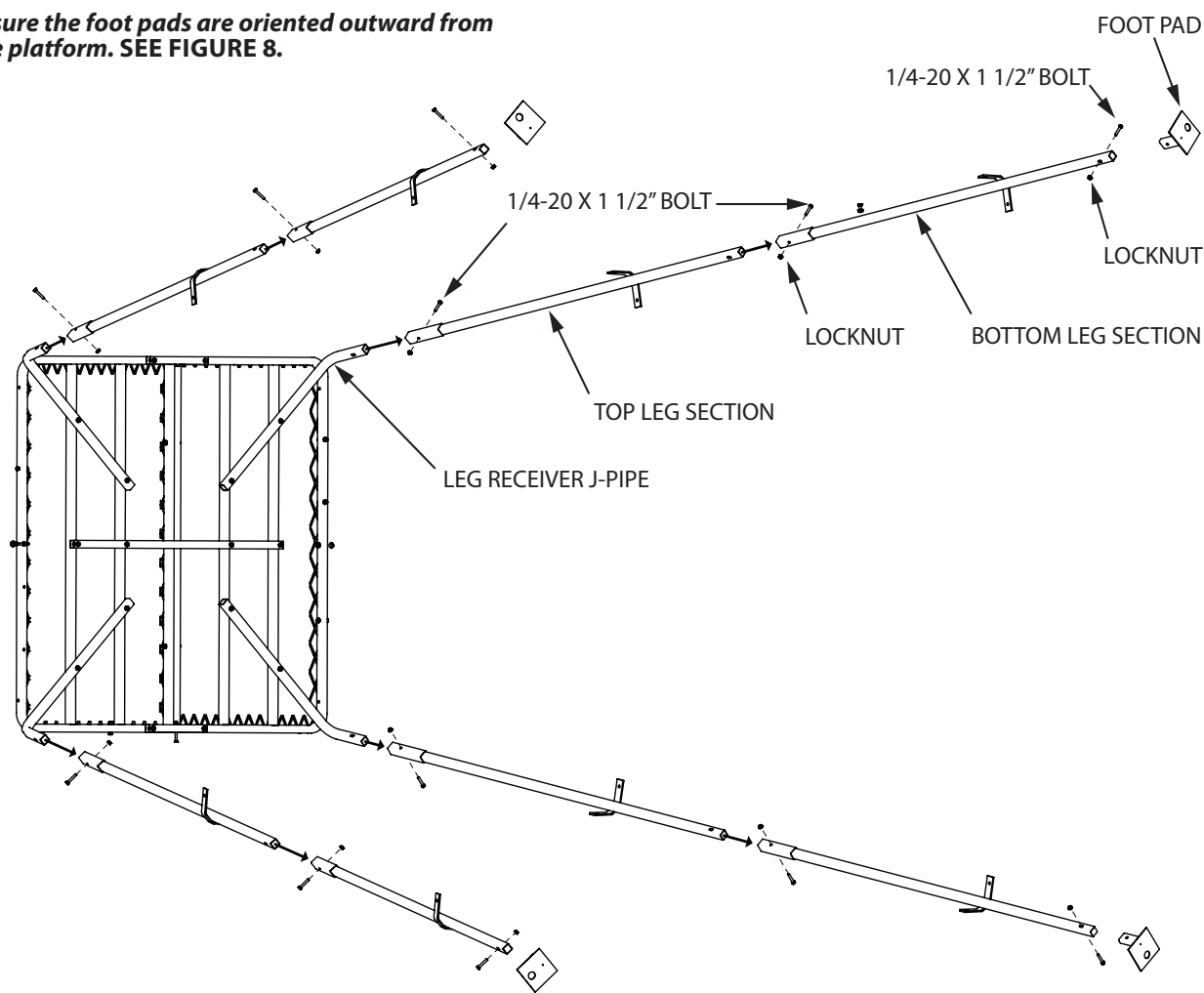

FIGURE 8

15. Assemble Cross Braces as follows:

- Locate the (8) male cross braces (TP132) and the (8) female cross braces (TP131). Insert the male cross braces into the female cross braces.
- Using (8) provided 1/4-20 x 1-1/4" bolts and locknuts, secure the cross braces in the hole location listed in **FIGURE 9**. When assembled together, all eight cross brace assemblies should measure approximately 88-3/4" from end to end.

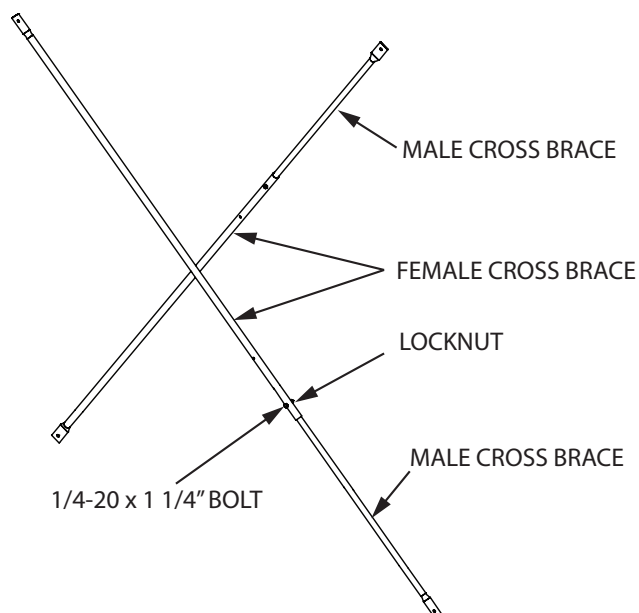

FIGURE 9

16. Assemble Double Flat Braces as follows:

- Attach (2) double flat braces (TP135) to the bottom hole of each blind upright (TWR18) that is already attached to the long side of each platform using (2) provided 1/4-20 x 1-1/2" bolts and locknuts. **SEE FIGURE 10.**
- Attach remaining (2) double flat braces to blind uprights/platform joiner tubes using (2) provided 1/4-20 x 2-1/2" bolts and locknuts. **SEE FIGURE 10.**

NOTE: You will use the same 2-1/2" bolt and locknut that is already holding the blind uprights to the platform joiner tubes.

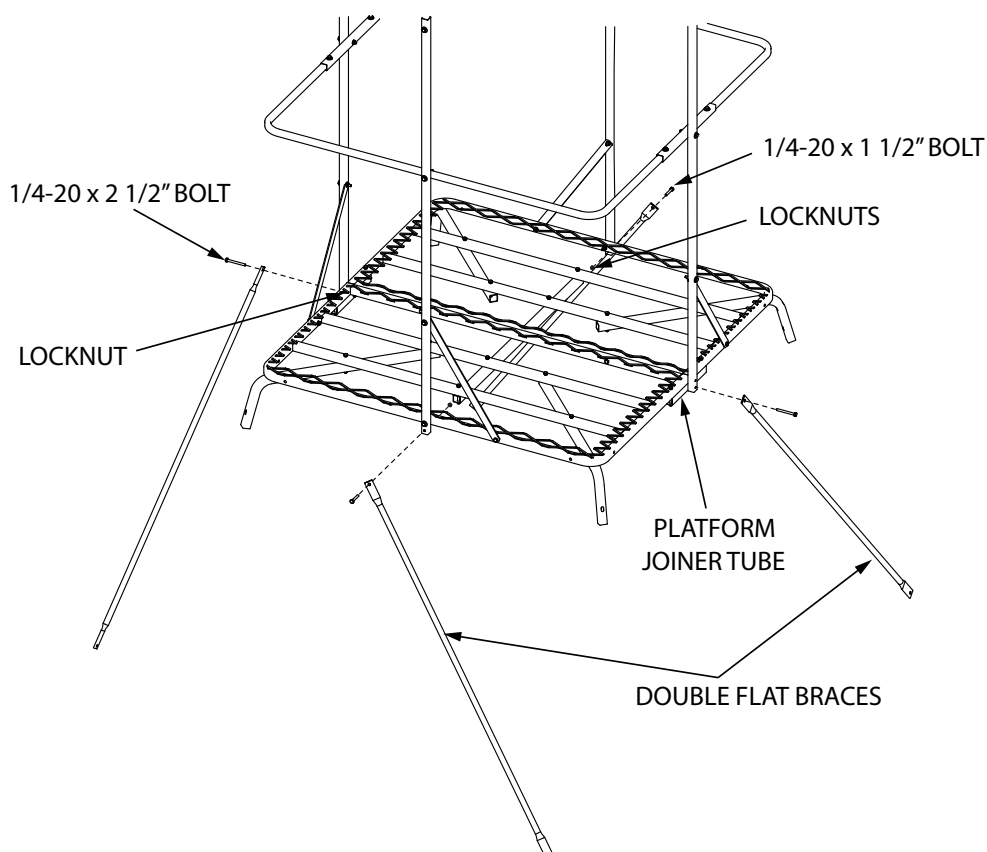

FIGURE 10

17. Install Cross Braces as follows:

- a. Attach the opposite end of all four double flat braces to the wing bracket of each top leg section using (4) provided 5/16-18 x 1-1/4" bolts and locknuts. **SEE FIGURE 11.**

IMPORTANT ASSEMBLY NOTE:

Be sure to use 1-1/4" bolts at any location where multiple cross brace poles are attached!

- b. Attach (2) cross brace assemblies to wing brackets of leg sections, on each side of the tower (8 total cross brace assemblies), using (12) provided 5/16-18 x 3/4" bolts, (4) 5/16-18 x 1-1/4" bolts and (16) locknuts. **SEE FIGURE 11.**

NOTE: You will use the 5/16-18 x 1-1/4" bolts and nuts that are already holding the double flat braces.

18. Once all cross braces are attached to tower legs, **you must now tighten all nut & bolt assemblies. Be sure not to over tighten or crush tubing when tightening! Double and triple check all nut and bolts to make sure all are securely fastened.**

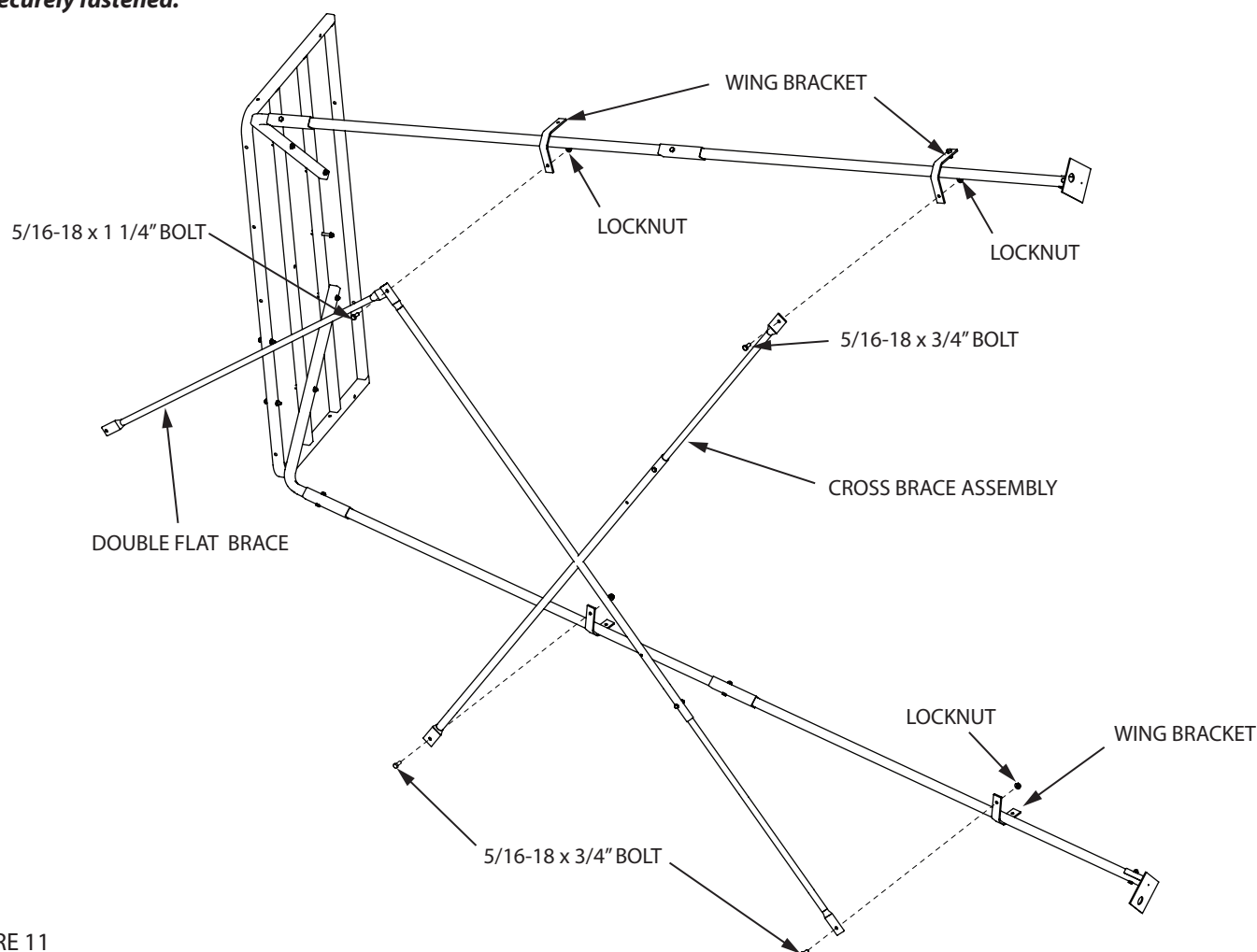

FIGURE 11

19. Assemble the (3) ladder sections on the ground in the following order: bottom section (AL1 ladder); second section (AL3 ladder); top section (TWR21 ladder). **SEE FIGURE 12.**
20. With all ladder sections assembled together on ground, secure all sections together using (4) provided 1/4-20 x 1-1/4" bolts and locknuts. **SEE FIGURE 12.**
21. Attach the (2) height adjuster feet (TWR41) to the bottom ladder section using (2) provided 1/4-20 x 1-1/2" bolts and lock nuts. **SEE FIGURE 12.**

NOTE: Adjustment in height may be needed when tower is uprighted later in instructions. Channel on adjuster feet should cradle on three sides of the ladder leg sections.

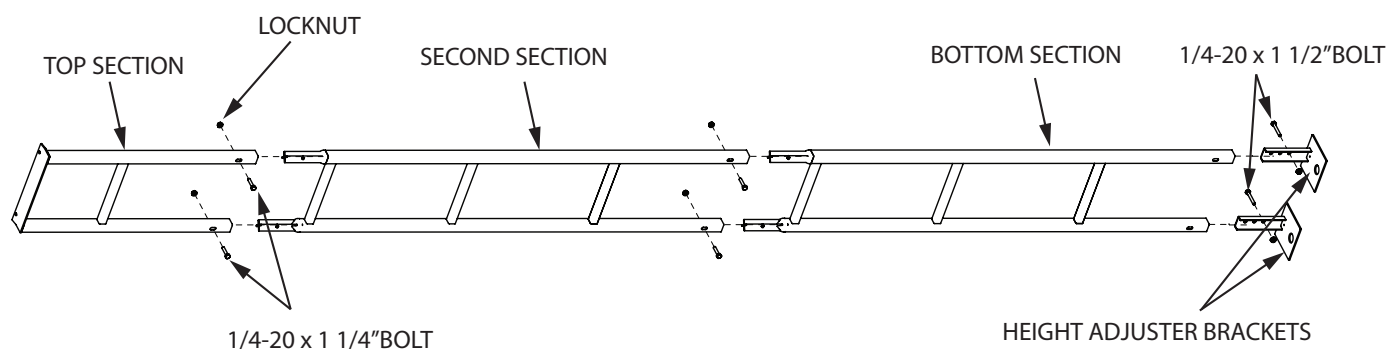

FIGURE 12

22. Attach assembled ladder to the platform using (2) provided 1/4-20 x 1-3/4" bolts and locknuts. See figure 13. Plate of top ladder section should be mounted on top side of platform.

NOTE: Ladder can be bolted to long side of either platform, they are the same.

23. Attach the ladder assembly to the cross braces using the (2) provided U-bolts/backup plates/nyloc nuts and tighten securely. This will hold the ladder securely to the cross braces. See figure 13.
24. Go over every detailed step of assembly to be sure all assembly is done correctly and all bolt locations are secured and snug. Be sure not to over tighten or crush tubing when tightening!
25. The camo blind cover (48028) can now be positioned over the upper frame work.

NOTE: Supporting platform end of tower slightly off ground will be needed to slide blind over frame work.

- Locate the door opening and align it with the top of the ladder.
- Stretch sewn in bungee cord on bottom edge of blind around platform corners/edges to get a snug fit.
- The webbing straps in each corner can be fed around the platform J-pipes and back through platform mesh. Feed long strap through tri-slide. Pull strap tight so blind will be attached to platform. Repeat for all 4 corners of blind.
- The Velcro straps located on each side can be fed around the platform frame and back through platform mesh and secured.

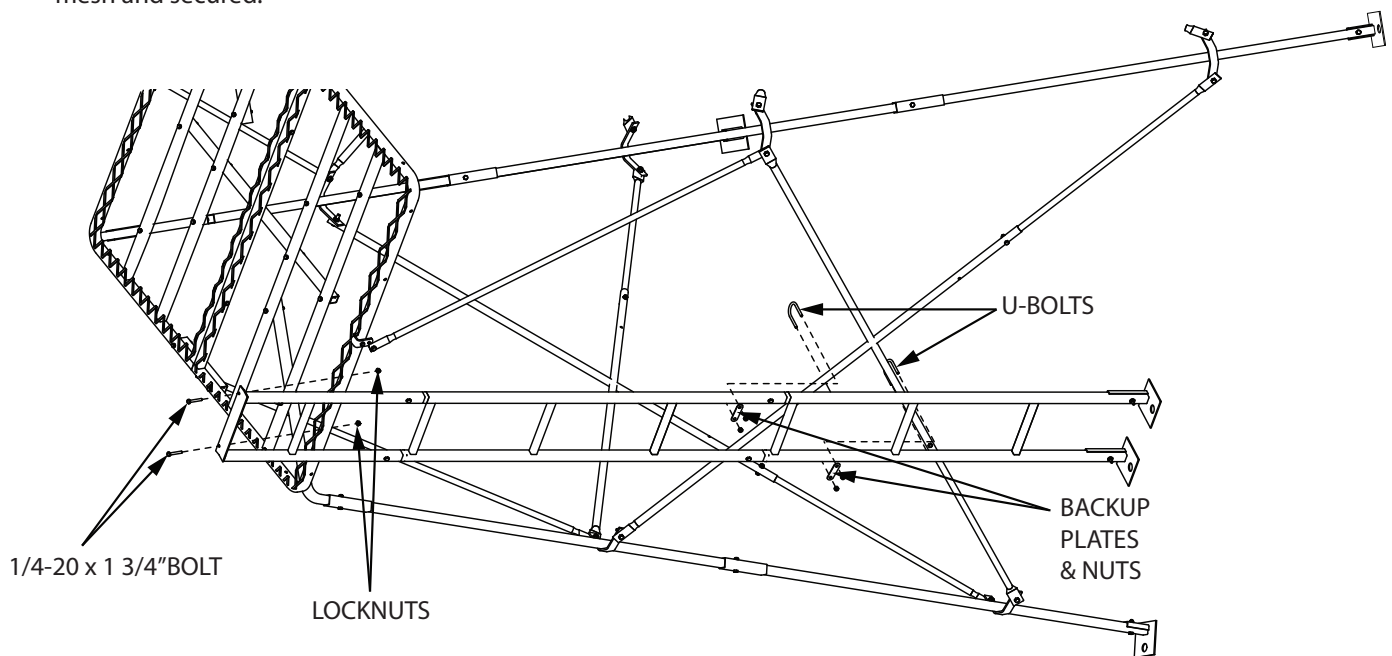

FIGURE 13

UPRIGHTING AND USE INSTRUCTIONS

1. With assembled product lying on ground, position two people at feet end of tower laying on ground. These people have to prevent the bottom end from tilting up when platform end is lifted and prevent feet from skidding across the ground.
2. Position two people at platform end, lift platform end of tower and continue uprighting by walking toward feet end and moving hands along leg sections. As tower goes over-center, slowly allow the tower to land on the opposite legs section. Be sure all people are clear to prevent injury.
3. Tower may need to be positioned to allow for a level stand and all legs touching ground. Avoid rocks or anything that may hinder this from happening. Only move tower with four people, one on each leg. Each person should lift equally and only enough to shift tower to a level ground location. **DO NOT lift tower by round cross braces as you could bend or damage them.** The ladder height adjuster brackets may need to be repositioned so they contact the ground firmly.
4. Drive (4) ground stakes (not included) through the holes in the (4) feet. Stakes should be approximately 24" in length with 18" in ground and should be driven in at an angle. **SEE FIGURE 14.**
5. Climb ladder slowly and carefully keeping a constant hand grip on ladder at all times. Lean forward, towards ladder as you climb. Be sure hands are free for climbing. Continue up onto the platform.
6. Unzip access door for entry. Door may be zipped closed once inside blind. Windows can be configured in multiple positions for versatility.
7. **REVERSE UPRIGHTING AND USE INSTRUCTIONS TO TAKE TOWER DOWN.**

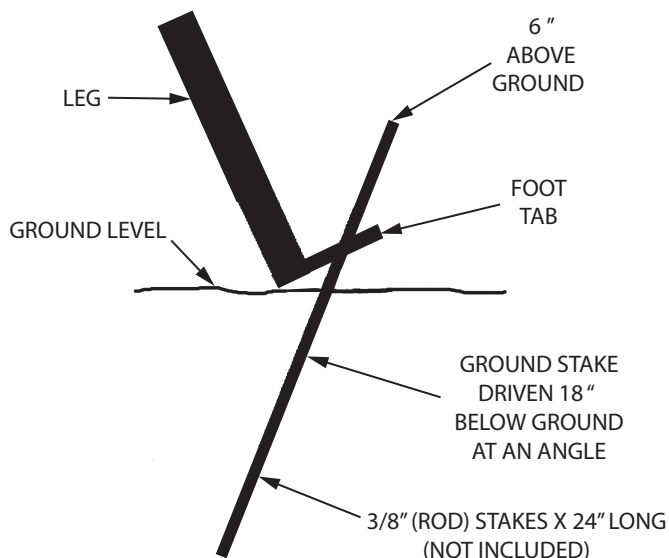

FIGURE 14

! WARNING

READ, UNDERSTAND AND FOLLOW ALL ASSEMBLY, INSPECTION, MAINTENANCE, & USE INSTRUCTIONS PROVIDED BEFORE EACH USE. FAILURE TO FOLLOW ALL WARNINGS AND INSTRUCTIONS COULD RESULT IN SERIOUS INJURY OR DEATH.

BE SURE TO DOUBLE AND TRIPLE CHECK ENTIRE ASSEMBLY PROCESS. ALL ASSEMBLY MUST BE COMPLETE. ALL NUTS AND BOLTS MUST BE TIGHT BY USING THE CORRECT WRENCHES. DO NOT OVERTIGHTEN OR CRUSH TUBING!

BE SURE UPRIGHTING AREA IS OPEN, FLAT, LEVEL, AND DRY WITH NO POWER LINES NEAR!

IF ALL ASSEMBLY IS NOT COMPLETE AND/OR PRODUCT IS USED IN AN AREA NOT RECOMMENDED, YOU COULD BE SERIOUSLY INJURED OR DEATH MAY OCCUR.

DO NOT USE ANY TYPE OF MOTORIZED VEHICLE TO UPRIGHT THIS TOWER. YOU COULD CAUSE UNNECESSARY DAMAGE TO THE PRODUCT! UPRIGHT BY HAND ONLY USING FOUR PEOPLE, TWO PEOPLE AT FEET END OF TOWER AND TWO PEOPLE AT PLATFORM END. BE AWARE IT IS "TOP" HEAVY. USE GREAT CARE AND CAUTION DURING THIS PROCESS TO PREVENT AN OFF BALANCE FALL TO PREVENT INJURY.

AS TOWER STAND GOES OVER-CENTER, BE SURE TO SLOWLY ALLOW THE TOWER TO LAND ON THE OPPOSITE LEG SECTIONS. BE SURE ALL PEOPLE ARE CLEAR TO PREVENT INJURY.

GROUND STAKES ARE NECESSARY TO HELP PREVENT INJURY AND/OR PRODUCT DAMAGE FROM TIPPING OVER IN STRONG WINDS! IT IS HIGHLY RECOMMENDED THAT YOU PURCHASE AND USE THE UNIVERSAL TIE-DOWN KIT WITH GROUND STAKES WITH THIS PRODUCT TO HELP PREVENT PERSONAL INJURY AND/OR PRODUCT DAMAGE FROM TIPPING OVER IN STRONG WINDS!

PRACTICE INSTALLING, ADJUSTING, AND USING STAND AT GROUND LEVEL FIRST.

ALWAYS HAVE THREE POINTS OF CONTACT WHILE CLIMBING THE LADDER.

MAKE SURE TO ALWAYS LEAN FORWARD INTO THE LADDER WHEN ASCENDING OR DESCENDING.

ILLUSTRATED PARTS BREAKDOWN

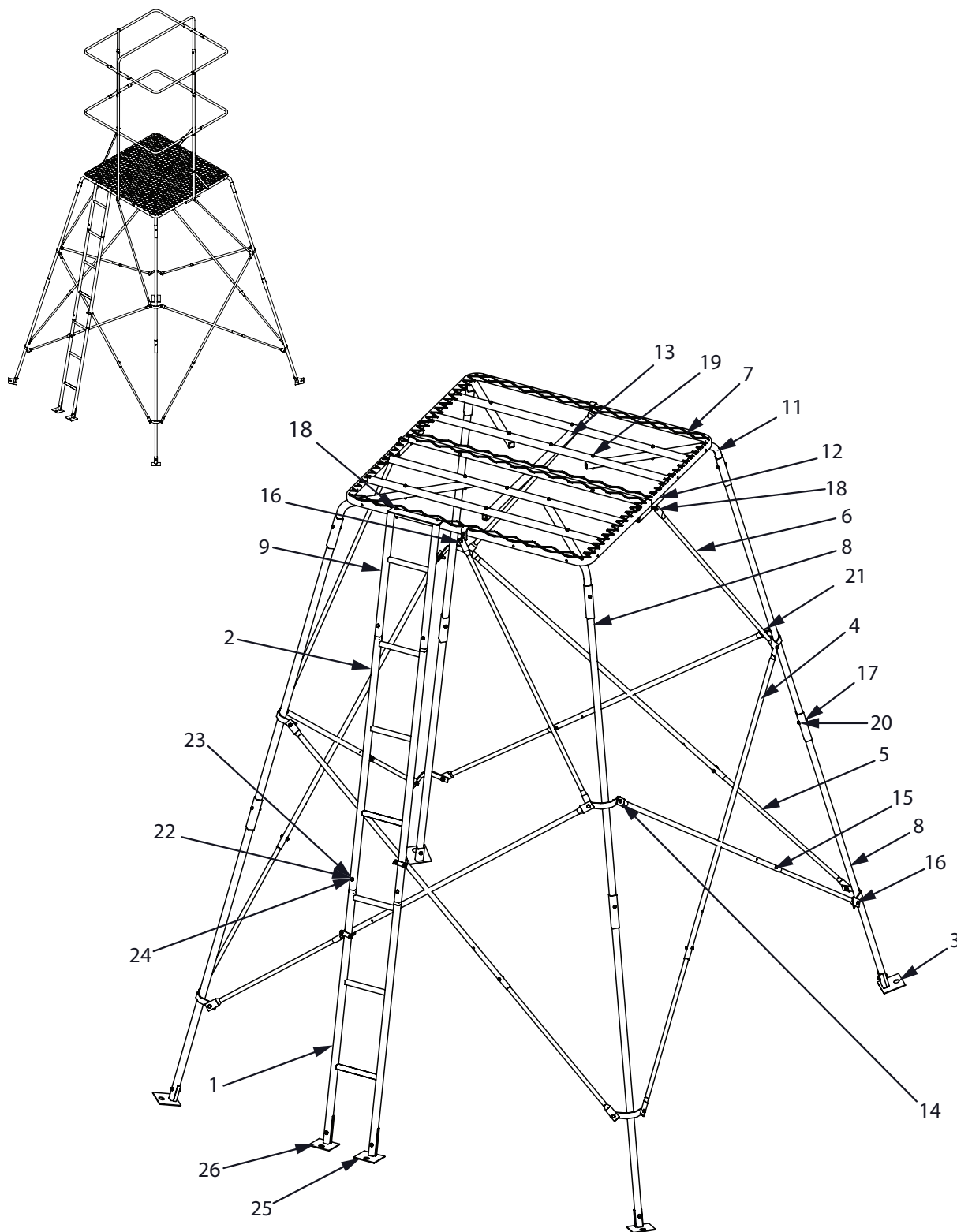

ILLUSTRATED PARTS BREAKDOWN

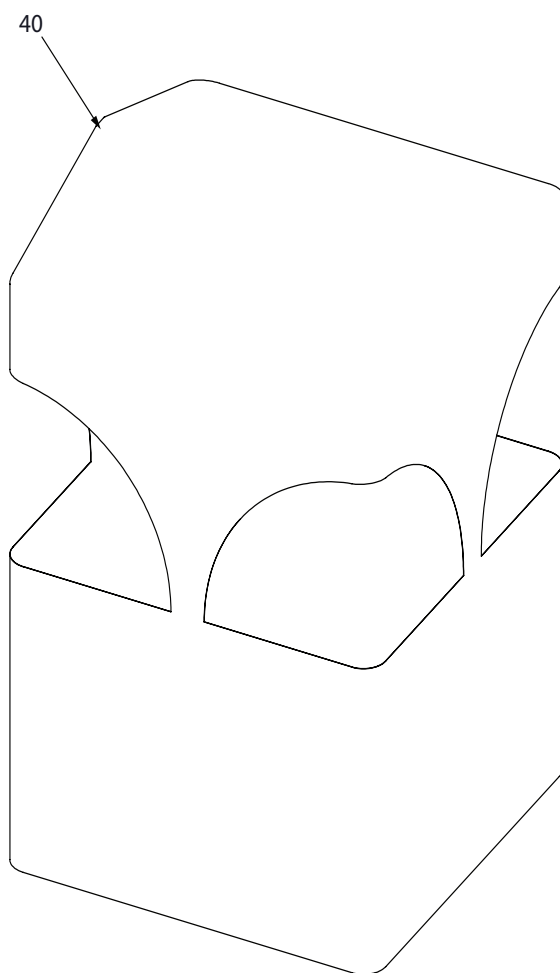
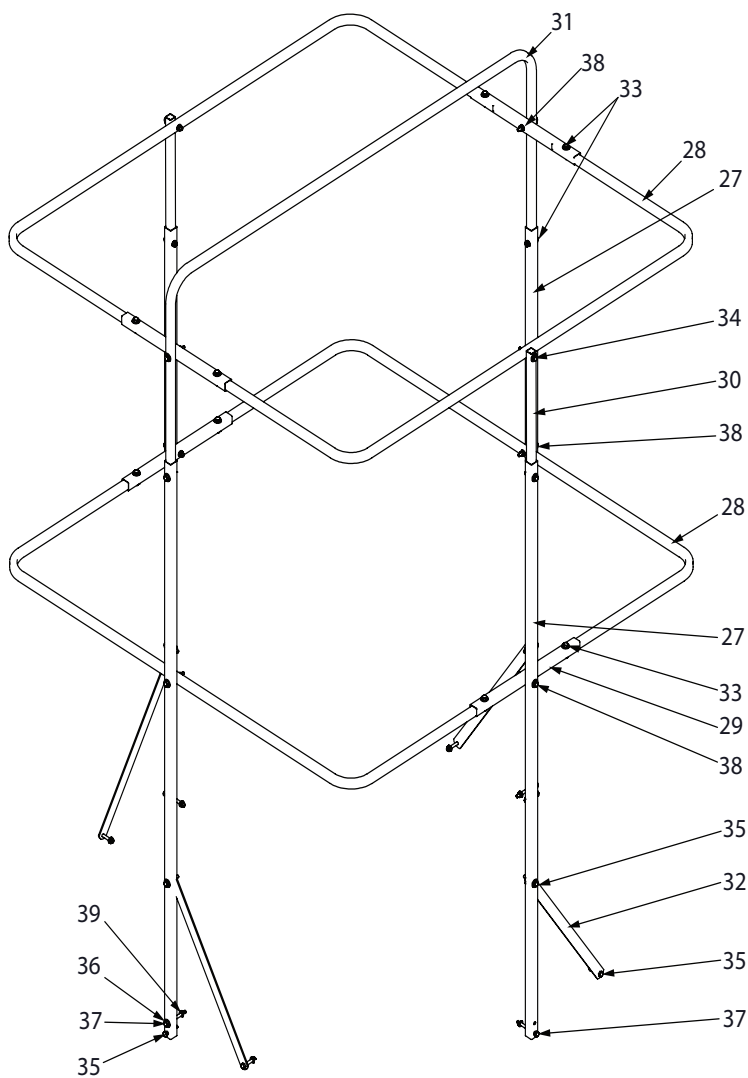

ILLUSTRATED PARTS BREAKDOWN

ITEM #	PART #	DESCRIPTION	QTY.
2	AL3	AP LADDER, 3-STEP PIN STYLE	2
3	TP113	FOOT PAD	4
4	TP131	BRACE, FEMALE CROSS 60"	8
5	TP132	BRACE, MALE CROSS 36"	8
6	TP135	BRACE, DOUBLE FLAT	4
7	TWR15	PLATFORM	2
8	TWR20	LEG	8
9	TWR21	LADDER TOP	1
10	--	--	--
11	TWR25	RECEIVER, LEG	4
12	TWR31	TUBE, PLATFORM, JOINER OUTSIDE	2
13	TWR32	TUBE, PLATFORM, JOINER CENTER	1
14	1401B	BOLT, HHCS 5/16-18 X 1-1/4" GR5 BLK	4
15	8909B	BOLT, HHCS 1/4-20 X 1-1/4" GR5 BLK	24
16	48151	BOLT, HHCS 5/16-18 X 3/4" GR5 BLK	14
17	48240B	BOLT, HHCS 1/4-20 X 1-1/2" GR5 BLK	14
18	48250B	BOLT, HHCS 1/4-20 X 1-3/4" GR5 BLK	6
19	48270B	BOLT, HHCS 1/4-20 X 2-1/2" GR5 BLK	18
20	48752B	NUT, FLANGED TOP LOCK 1/4-20	50
21	48753B	NUT, FLANGED TOP LOCK 5/16-18	18
22	63226	PLATE, BACKUP	2
23	63227	U-BOLT	2
24	67538B	NUT, HEX NYLOC	4
25	TWR41	HEIGHT ADJUSTER FEET	2
26	48240B	BOLT, HHCS 1/4-20 X 1-1/2" GR5 BLK	2
27	TWR18	RIM, UPRIGHT	4
28	TWR19	RAIL, RIM	4
29	TWR26	TUBE, RAIL SPANNER	4
30	TWR27	TUBE, EXTENSION	2
31	TWR28	RAIL, ROOF	1
32	SL8	FLAT BAR, SUPPORT	4
33	8909B	BOLT, HHCS 1/4-20 X 1-1/4" GR5 BLK	12
34	48153B	BOLT, HHCS 1/4-20 X 2" GR5 BLK	2
35	48240B	BOLT, HHCS 1/4-20 X 1-1/2" GR5 BLK	10
36	48261B	WASHER 1/4" BLK	46
37	48270B	BOLT, HHCS 1/4-20 X 2-1/2" GR5 BLK	6
38	48271B	BOLT, HHCS 1/4-20 X 2-1/4" GR5 BLK	6
39	48752B	NUT, FLANGED TOP LOCK 1/4-20	38
40	48028	BLIND COVER, CAMO	1

BOLT IDENTIFICATION CHART

Not all bolt sizes shown are included with all treestands. Bolts shown are for size reference only. Extra hardware may be included in the parts bag.

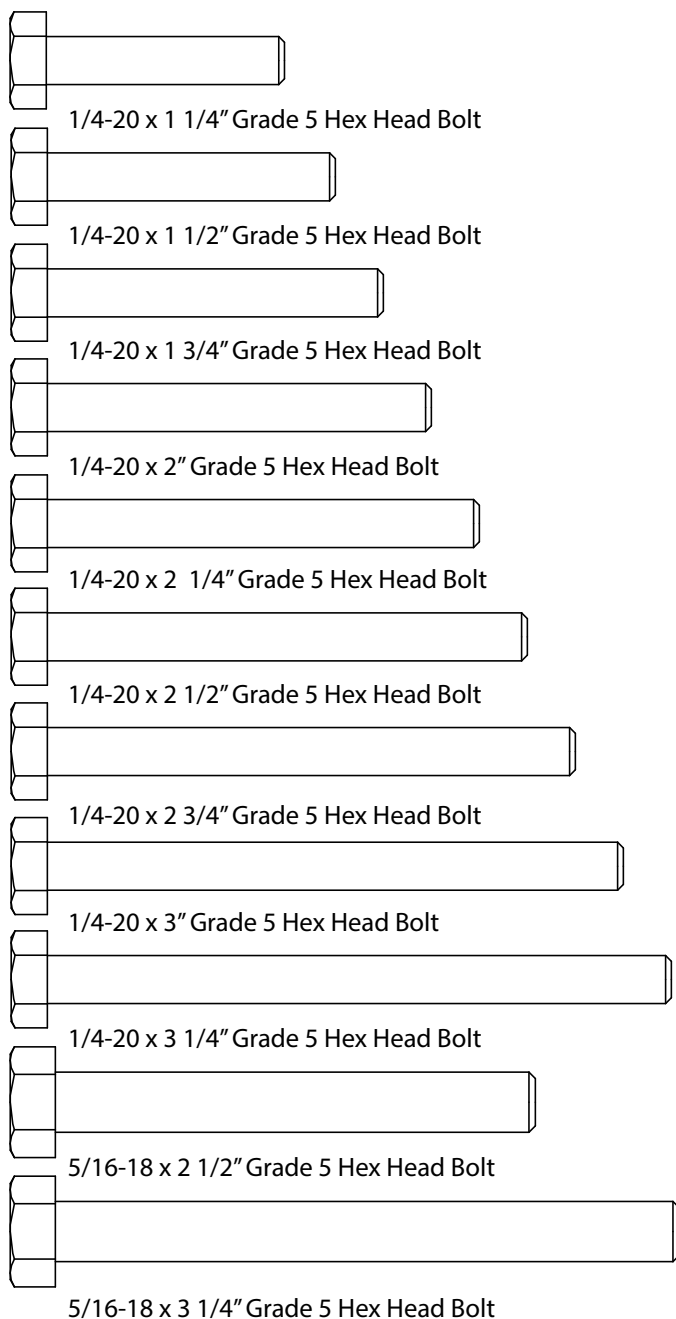

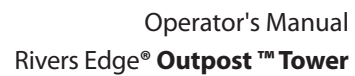
[illegible]



Rivers Edge® Treestands, Inc.
1160 Eighth Avenue, PO Box 755
Cumberland, WI 54829
800-450-EDGE (3343) | Fax 715-822-2124
Email: info@huntriversedge.com

*All weights, specifications and features are approximate and are subject to change without notice. Due to continuous product improvements, product images may not be exact. Warning labels in some product images may have been removed for photography purposes only. Props shown in photos not included. Some assembly may be required.